

of
 ot 2 of Certified Survey Map No. 1313,

Surveyed for: **Sam Eddins**
202 East Fourth Street
Hinsdale, Illinois. 60521

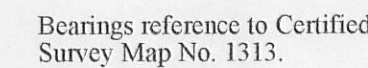

- 1) This survey plat is not certified unless signed and sealed in red ink.
- 2) This survey is subject to Wisconsin lien laws. This Plat of Survey is the notice of intent to file lien. Lien waiver required.

All rights reserved. No part of this survey plat may be reproduced or transmitted in any form by any means - graphic, electronic, or mechanical, including photocopying, tracing, or information storage and retrieval systems - without permission in writing from Douglas G. Olson, Jensen & Olson Land Surveying, LLC.

Douglas G. Olson
Wisconsin Registered Land Surveyor - 2093

Water elevation taken
March 26, 2009, is 864.60.

45 South Wisconsin Street * P.O. Box 322 * Elkhorn, Wisconsin. 53121
Telephone: (262) 723-3434 * Facsimile: (262) 723-8044

Legend

■	Found Concrete Monument	●	Deciduous Tree
▣	Found Rail	●	Coniferous Tree
○	Found Iron Pipe	○	Set Spindle
●	Found Iron Rod, 3/4" dia.	○	Set Cut Cross
○	Found Iron Rod, 3/4" dia.	○	Information
○	Set Cut Cross	○	Utility Pole
○	Information	○	Concrete Cover
○	Utility Pole	▨	Asphalt Surface
○	Concrete Cover	▨	Gravel Surface
▨	Asphalt Surface		
▨	Gravel Surface		

2009.098

Survey date: March 26, 2009.
Revisions: No. 1 - Topography & Trees